

GMC-JM74SW-30 Magnetic Catch With Switch

Features

- Waterproof switch built-in magnetic catch, functions as a catch and power switch depending on opening/closing of door or lid.
- Single-pole double-throw switch
- Conforms to the specified electrical appliances and materials in the Electrical Appliances and Material Safety Act (PSE)
- Can be installed vertically or horizontally. Processing for passing through power cord is required for horizontal installation.
- Body coated with resin prevents rusting and dust. Built-in switch is designed to meet IP67 rating
- Movable adsorption sheet of counter plate prevents malfunction of catch and switch

Notes

- Do not use as a door stopper to prevent damage
- Do not use in contact with steam, hot water and water. Do not leave strongly acidic or basic detergents to avoid deteriorating

Parts Included

- Counter plate

Specifications

Rated Voltage and Current	AC250V 5A (Load Resistance) AC125V 5A (Load Resistance) DC30V 5A (Load Resistance)
Insulation Resistance	Min. 100MΩ (DC500V)
Contact Resistance (Initial Value)	Max. 100MΩ
Min. Applicable Load	DC5V 160mA
Operating Temperature	-40~+80°C, Max. 60% RH (No Freezing and Condensation)
Lead Wire	Single Core Heat Resistant PVC Cord 0.75 mm ² (<PS> E Certification)



Switch Contact Type



The power switch operates depending on opening/closing of door or lid.

[Two Types of Operation Can Be Chosen by Selecting Connection]

- Connecting NO (Blue) and COM (Black)
Energised when the counter plate is in contact with the body.
- Connecting NC (Red) and COM (Black)
Energised when the counter plate and the body are separated.
Example) To turn on the inspection light when the door opens in cabinet etc., connect NC (red) and COM (black).

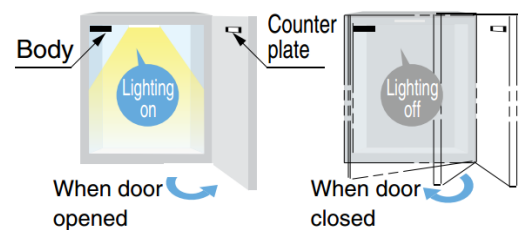
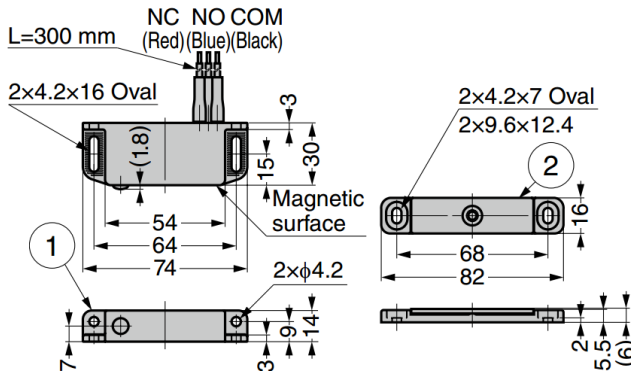

No.	Part Name	Material	Finish / Colour
①	Body	POM/Neodymium	Black
②	Counter Plate	POM/Stainless Steel (SUS430)	Black/Barrel Polished

Part No.	Magnetic Force	
GMC-JM74SW-30	29.4 N	3 kg